

1. Unscrew the handle hexagon socket screw with a hex driver; Adjust the handle direction as needed; Retighten the screw.

Installation Steps

1. Fold the template on the door and drill the holes accordingly, then put the lock mortise into the door frame.
 2. Fasten the mortise using four screws.
 3. Screw the connector nuts on the front panel and place the square spindle into the handle hole.
 4. Feed the wire harness through the door, fit the square spindle through the spindle hole on the lock mortise; push and hold the front panel on outside of the door, then hold the panel cover and waterproof pad on the inside, at last tighten the fixing screws.
 5. Connect the wire harness and tuck connector on the back panel.
 6. Place the spring into the handle hole on the back panel. Fit the thumb turn tailpiece to the through the latch on the lock mortise. Push and hold the back panel to the panel cover and then tighten the three fixing screws.
 7. Install the battery and battery cover.
- Press up and down the internal and external handles, twist thumb turn, and mechanical keys to check whether it works properly.

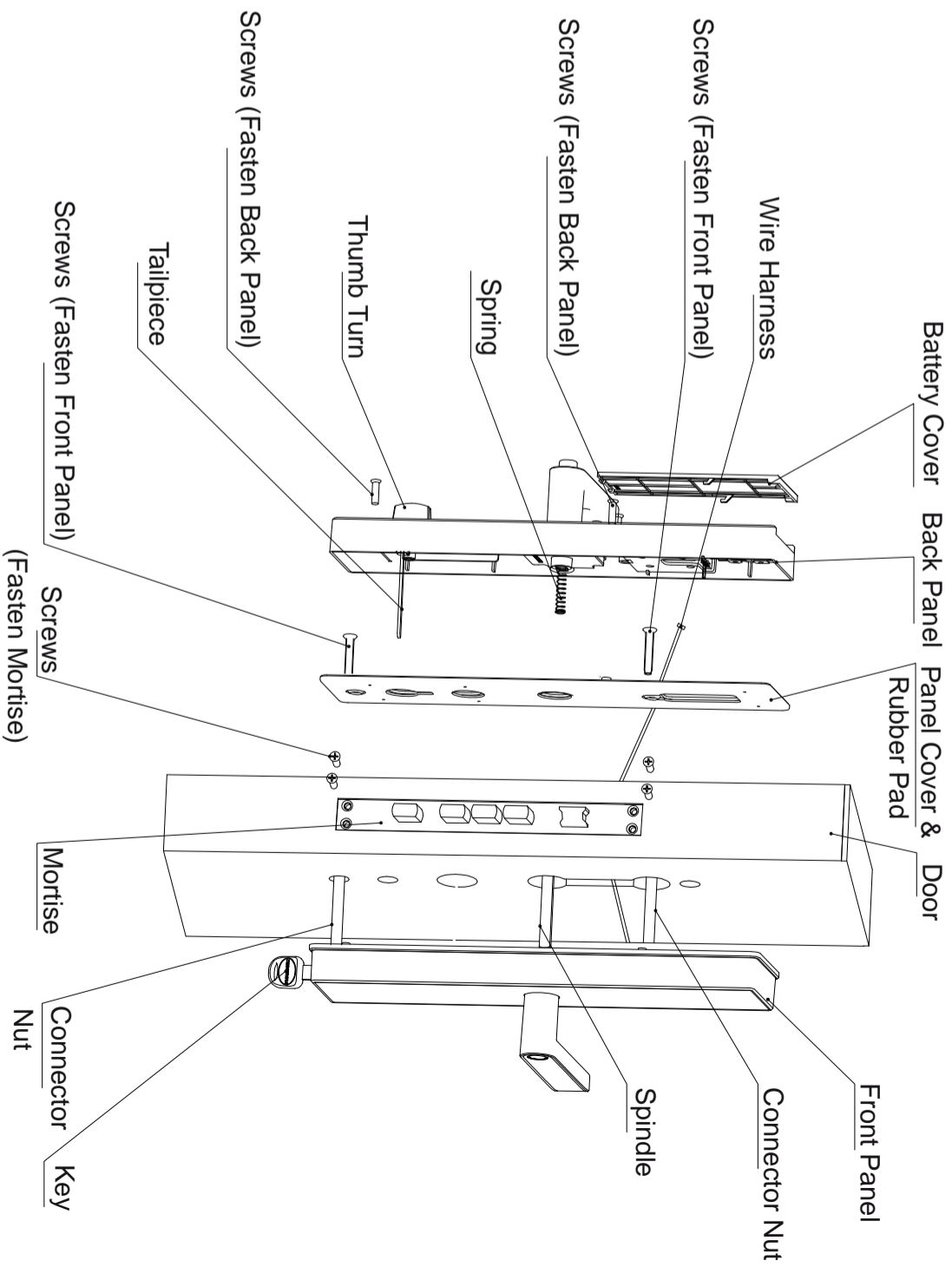

Attention:
To avoid the screw holes have deviation, please insert mortise after drilling the strike plate grooves, and then drilling the holes of screws according to actual.

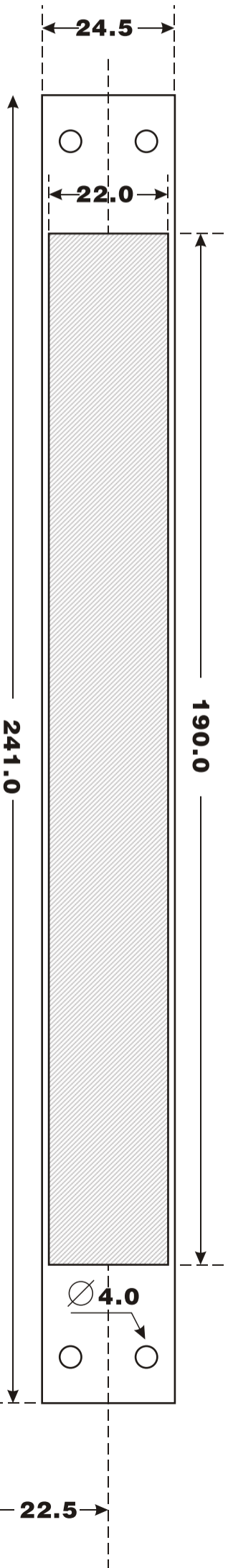

Note
The installation may need to be adjusted according to actual conditions of the door.

110/510/710/800
Installation Template Version: A0

